

Technical Data Sheet



Design: schmidtem design

BETTEAQUA WALL MOUNTED WASHBASIN

Wall mounted washbasin right angled, 1000 x 495 x 125 mm, enamelled, without a taphole or an overflow, incl. fastening material

article no.	A062
dimension	100 x 49,5 x 12,5 cm
Colours	can be delivered in white, colour range BETTEFLOOR and other sanitary colours
Extras	available with the easy-to-clean surface BETTEGLAZE® PLUS

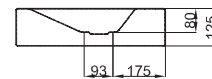
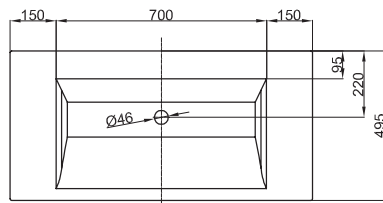

Recommended Taps

For optimal water fall you should use spouts with vertical outlet and aerator.

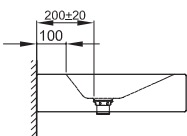

spout projection:
ca. 200 mm from wall

Dimensions for installation and connection

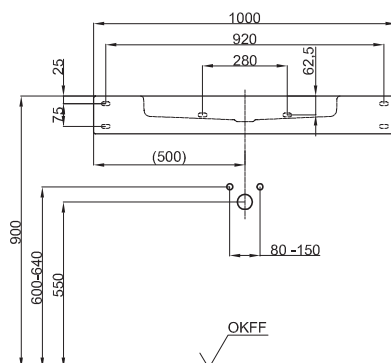

Subject to alteration and production tolerance.