

Technical Data Sheet



BETTEAQUA WALL MOUNTED WASHBASIN

Wall mounted washbasin right angled, 800 x 495 x 125 mm, enamelled, with a taphole, without an overflow, incl. fastening material

Design: schmidtem design

article no.	A054 HLW1
dimension	80 x 49,5 x 12,5 cm
Colours	can be delivered in white, colour range BETTEFLOOR and other sanitary colours
Extras	available with the easy-to-clean surface BETTEGLAZE® PLUS



Recommended Taps

For optimal water fall you should use spouts with vertical outlet and aerator.

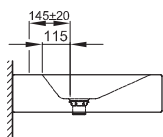

spout projection:
ca. 145 mm from centre of taphole

Dimensions for installation and connection

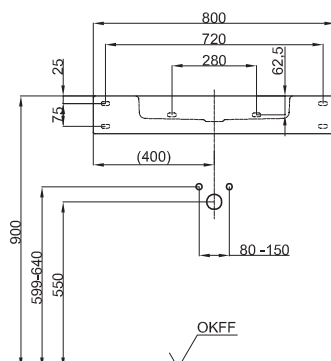

Subject to alteration and production tolerance.