

## Technical Data Sheet



### BETTEAQUA WALL MOUNTED WASHBASIN

Wall mounted washbasin right angled, 600 x 495 x 125 mm, enamelled, with a taphole, without an overflow, incl. fastening material

Design: schmidtem design

article no.	A056 HLW1
dimension	60 x 49,5 x 12,5 cm
Colours	can be delivered in white, colour range <b>BETTEFLOOR</b> and other sanitary colours
Extras	available with the easy-to-clean surface <b>BETTEGLAZE® PLUS</b>



### Recommended Taps

For optimal water fall you should use spouts with vertical outlet and aerator.

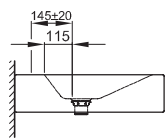

spout projection:  
ca. 145 mm from centre of taphole

### Dimensions for installation and connection

