

## Technical Data Sheet



### BETTEAQUA BUILT-IN WASHBASIN

Built-in washbasin right angled, 600 x 435 x 9 mm, enamelled, without a taphole or an overflow, incl. fastening material

Design: schmidtem design

Section dimensions

Fitting from below: 440 x 365 mm

article no. A051

dimension 60 x 43,5 x 0,9 cm

Colours can be delivered in white, colour range **BETTEFLOOR** and other sanitary colours

Extras available with the easy-to-clean surface **BETTEGLAZE® PLUS**

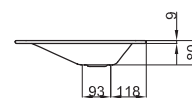
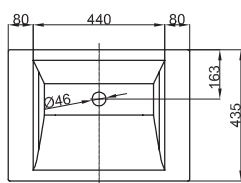

### Recommended Taps

For optimal water fall you should use spouts with vertical outlet and aerator.

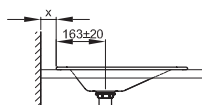

spout projection:  
distance to wall x mm + ca. 163 mm from outer edge