

VAIO DUO

- bathing with a friend: two identical back rests and centrally positioned waste
- with integrated arm rests
- classic four-cornered model
- made of Kaldewei steel enamel 3,5 mm



Similar illustration

Please notice:

The illustrated bath with grip/handle requires a special bath design. To attach the grip/handle, a special drilling (standard positioning) in the bath is required (already included in the accessory price).

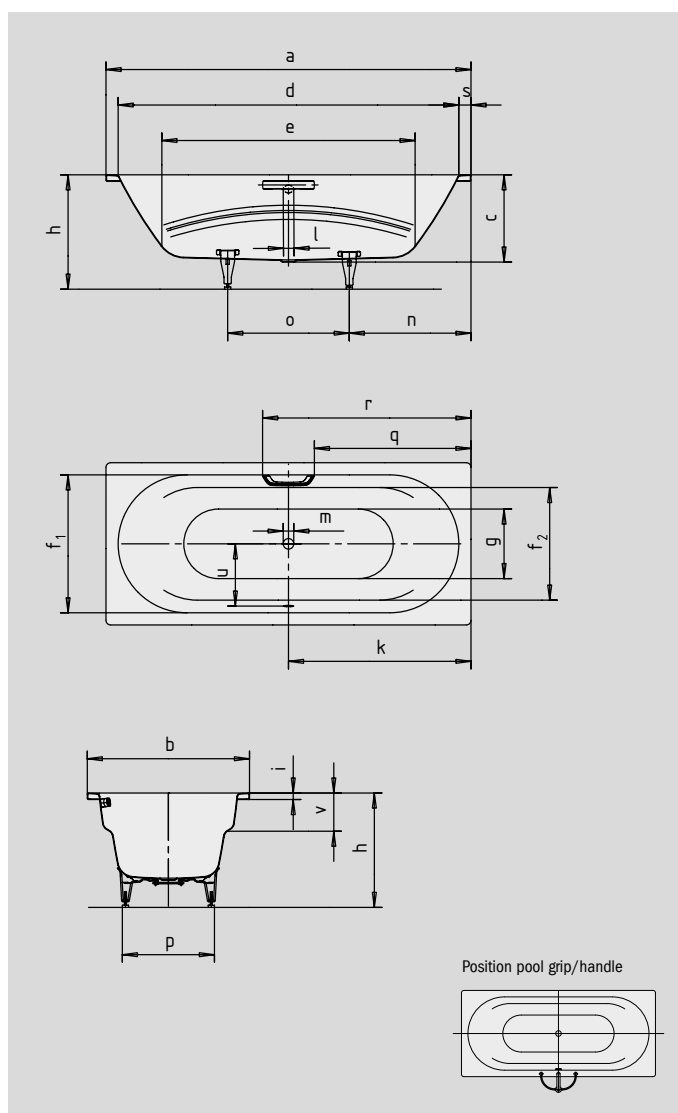

DISCREET OPULENCE AMBIENTE COLLECTION

COMFORT SELECT



Model No.		950
External length	a	1800 mm
External width	b	800 mm
Depth	c	430 mm
Internal length (top)	d	1680 mm
Internal length (bottom)	e	1248 mm
Internal width (top)	f ₁ , f ₂	680; 555 mm
Internal width (bottom)	g	496 mm
Height with feet	h	550-590 mm
Height of rim	i	32 mm
Distance top edge to centre of overflow hole	j	70 mm
Distance bath edge to centre of drain hole	k	900 mm
Diameter of overflow hole	l	52 mm
Diameter of drain hole	m	52 mm
Distance foot end of bath edge to centre of foot	n	600 mm
Distance between the feet	o	600 mm
Max. width of feet	p	455 mm
Distance bath edge (foot end) to where grip/handle starts	q	772 mm
Distance bath edge (foot end) to where grip/handle ends	r	1028 mm
Width of rim (foot end)	s	60 mm
Distance between centre holes	u	332 mm
Armrest depth	v	180 mm
Water volume** in litres		155
Weight of the enamelled bath in kg		54
Anti-slip		Ø 435 mm
Full anti-slip		900 x 300 mm

Subject to technical alterations, tolerances and errors. Similar illustration.
 ** 70 litres displacement on average.

KALDEWEI