

CLASSIC DUO

- pure simplicity and unpretentious elegance are what distinguish these baths
- bathing with a friend: two identical back rests and centrally positioned waste
- classical four-cornered model
- made of Kaldewei steel enamel 3,5 mm



Similar illustration

Please notice:
The illustrated bath with grip/handle requires a special bath design.
To attach the grip/handle, a special drilling (standard positioning) in the bath is required (already included in the accessory price).

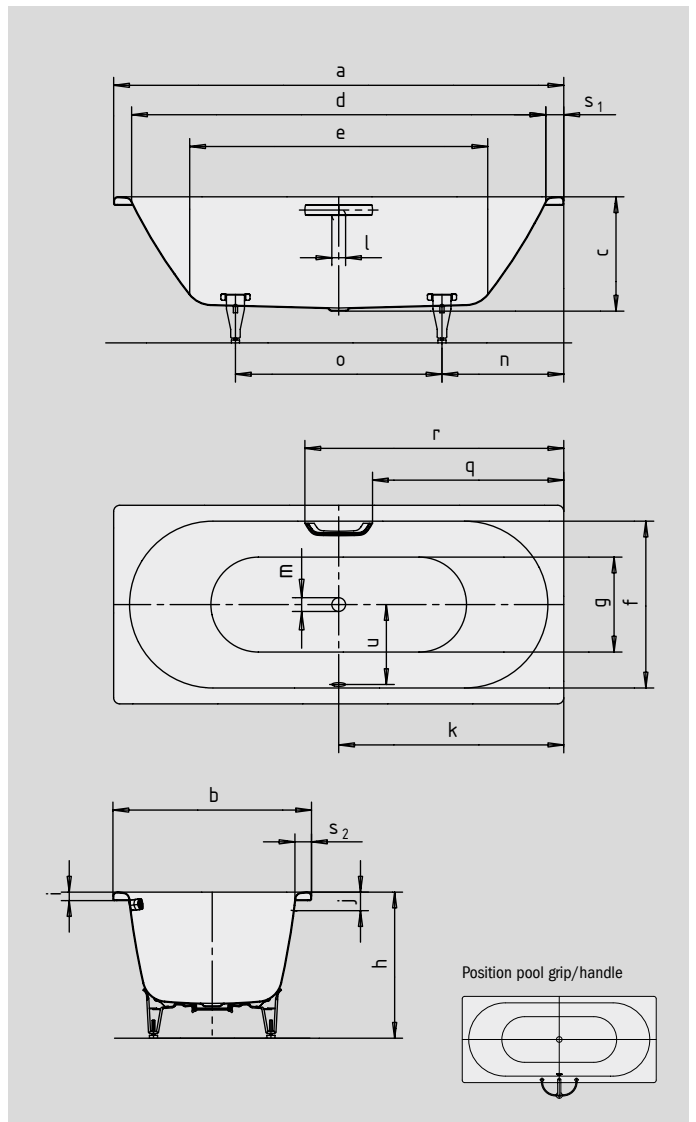

DISCREET OPULENCE AMBIENTE COLLECTION

COMFORT SELECT



Model No.		109	110	114
External length	a	1800	1800	1900 mm
External width	b	750	800	900 mm
Depth	c	430	430	430 mm
Internal length (top)	d	1680	1680	1780 mm
Internal length (bottom)	e	1230	1230	1330 mm
Internal width (top)	f	630	680	780 mm
Internal width (bottom)	g	500	550	650 mm
Height with feet	h	560-595	555-590	550-580 mm
Height of rim	i	32	32	32 mm
Distance top edge to centre of overflow hole	j	70	70	70 mm
Distance bath edge to centre of drain hole	k	900	900	950 mm
Diameter of overflow hole	l	52	52	52 mm
Diameter of drain hole	m	52	52	52 mm
Distance foot end of bath edge to centre of foot	n	600	600	630 mm
Distance between the feet	o	600	600	640 mm
Max. width of feet	p	470	540	650 mm
Distance bath edge to where grip/handle starts	q	772	772	822 mm
Distance bath edge to where grip/handle ends	r	1028	1028	1078 mm
Width of rim (foot end; lengthwise)	s ₁ ; s ₂	60; 60	60; 60	60; 60 mm
Distance between centre holes	u	305	330	380 mm
Water volume** in litres		143	158	213
Weight of the enamelled bath in kg		50	53	62
Anti-slip		∅ 435	∅ 435	∅ 435 mm
Full anti-slip		900 x 300	900 x 300	1097 x 406 mm

Note: The operational system may protrude on some whirl systems.
Please refer to the Technical Information for Whirl Systems for further information.
Subject to technical alterations, tolerances and errors. Similar illustration.
** 70 litres displacement on average.

KALDEWEI