



Vetreria Vistosi S.r.l.
info@vistosi.it
www.vistosi.com

CANDELA

SP D1 G9

CANDELA SP D1

Design ONO

A pendant made with blown cased glass. Its narrow diameter needs a good deal of skill to blow a piece with even thickness. Thanks to its light source, Candela offers a fascinating light effect.



AZIENDA CERTIFICATA UNI EN ISO 9001:2000

SIZE

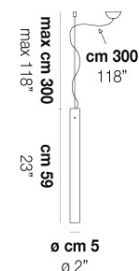

ALTERNATIVE VERSIONS

Click on the version to go to the web version of the product

VOLUME: Mc 0,05

GROSS WEIGHT: Kg 2,8

NET WEIGHT: Kg 1,3

SHADE FINISHING



BC WHITE

FRAME FINISHING



CR CHROME

MARKS:



BULBS:

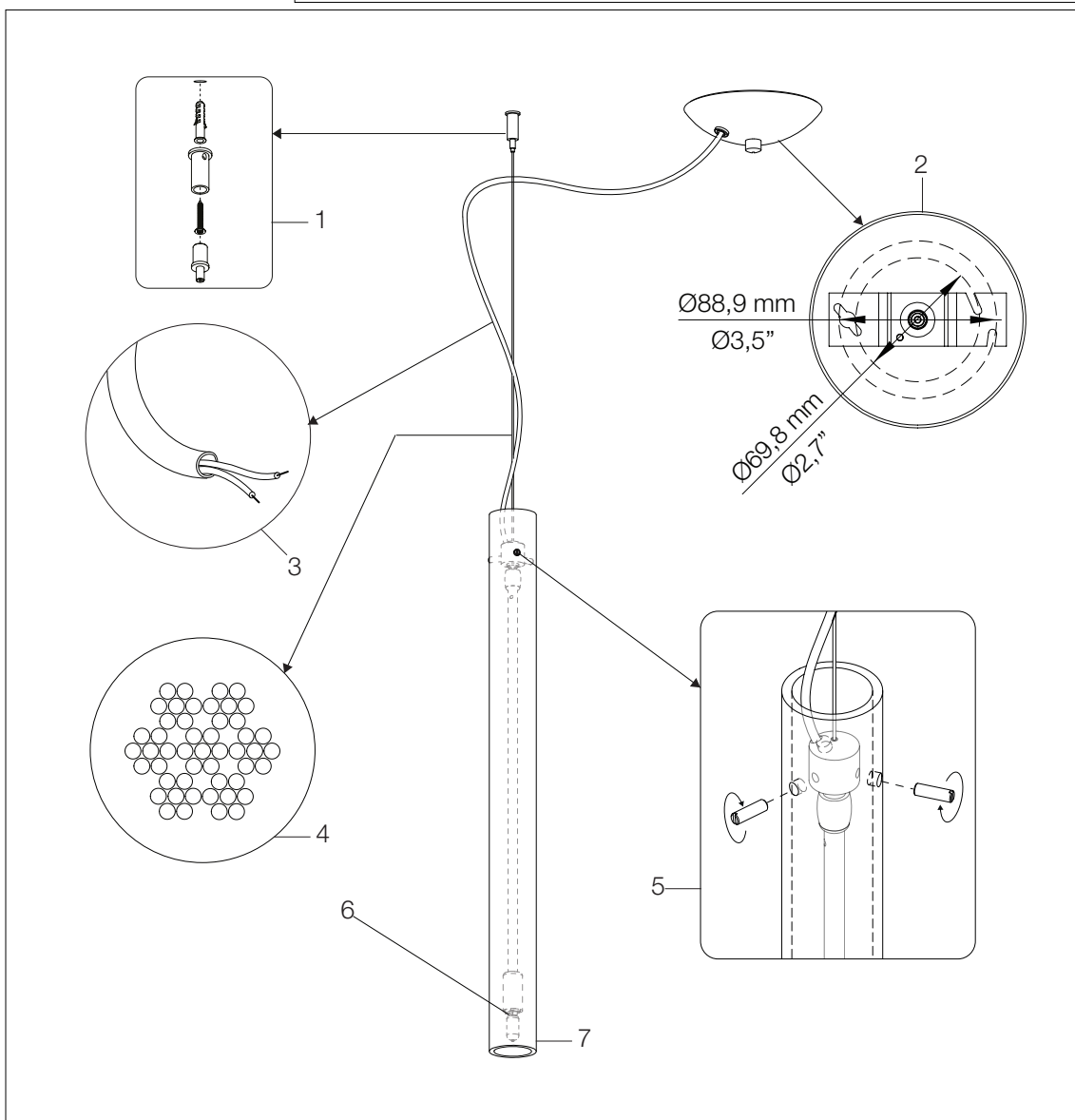

1

Detail of the component used for fixing the lamp to the ceiling. It is composed of a metallic cylinder, threaded regulator for stainless steel rope, dowel and screw.

2

Metal canopy with bracket on the ceiling and measures of distances between holes.

3

2-lines electric wire, section of cables 2x0,75mm² and triple insulation in FEP/FEP + FEP

4

Stainless steel rope crease resistant of Ø1,2 mm composed of 7x7 wires.

5

Detail of the fastening system used to fix the lampshade to the frame.

6

Ceramic lamp holder T° 250 connection type G9.

7

Light diffuser in white crystal glass, mouth blown and handmade. Unleaded glass of average thickness 4mm. Color obtained in the mixture and not painted.



Vetreria Vistosi S.r.l.

info@vistosi.it

www.vistosi.com

CANDELA

SP G9

CANDELA SP

Design ONO

A pendant made with blown cased glass. Its narrow diameter needs a good deal of skill to blow a piece with even thickness. Thanks to its light source, Candela offers a fascinating light effect.



AZIENDA CERTIFICATA UNI EN ISO 9001:2000

SIZE

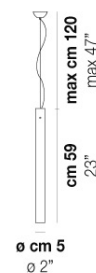

ALTERNATIVE VERSIONS

Click on the version to go to the web version of the product

D1

VOLUME: Mc 0,05

GROSS WEIGHT: Kg 2,7

NET WEIGHT: Kg 1,2

SHADE FINISHING



BC WHITE

FRAME FINISHING



CR CHROME

MARKS:

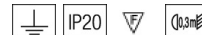

BULBS:

ALO 1x60w

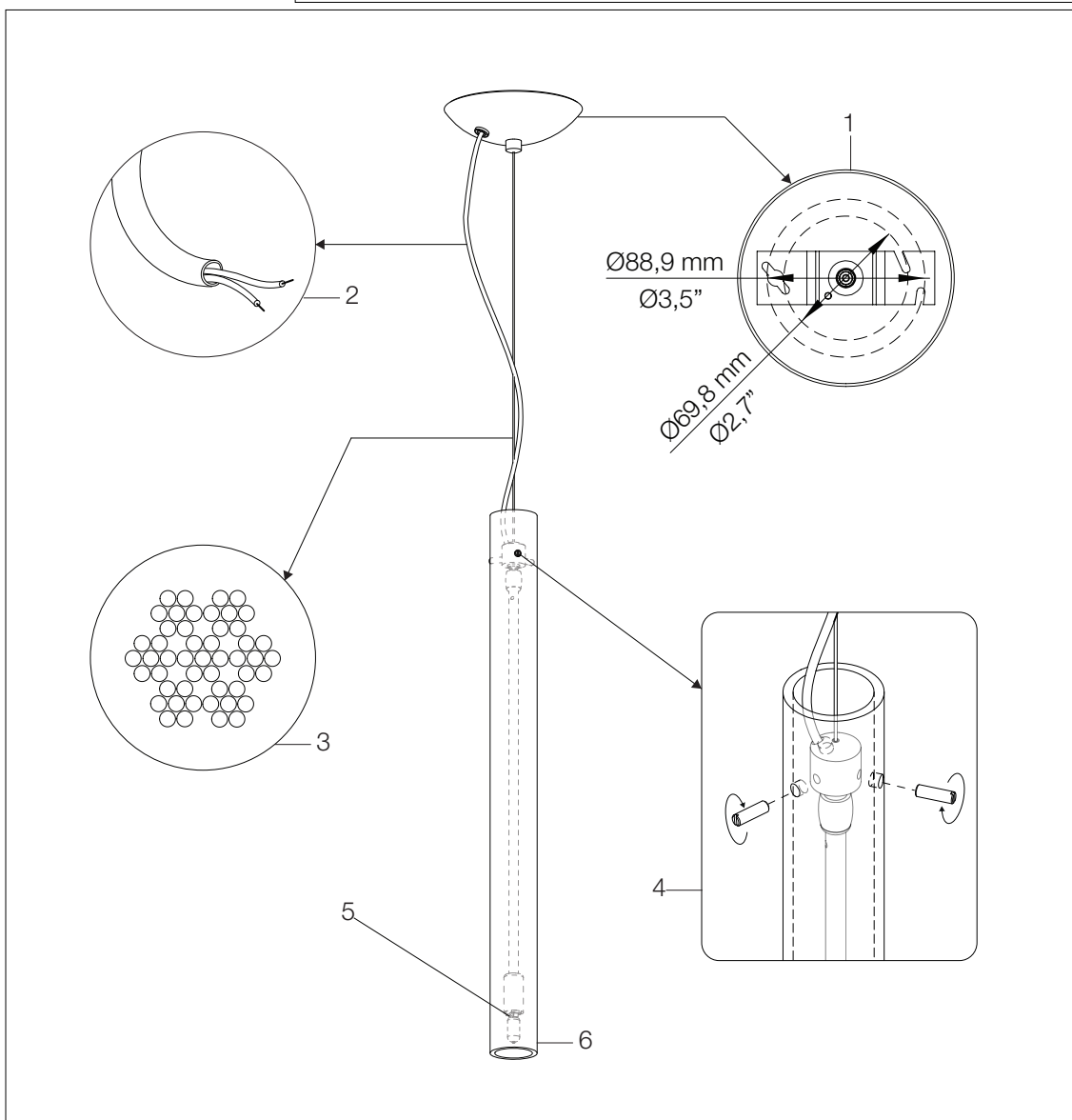

1

Metal canopy with bracket on the ceiling and measures of distances between holes.

2

2-lines electric wire, section of cables 2x0,75mm² and triple insulation in FEP/FEP + FEP

3

Stainless steel rope crease resistant of Ø1,2 mm composed of 7x7 wires.

4

Detail of the fastening system used to fix the lampshade to the frame.

5

Ceramic lamp holder T° 250 connection type G9.

6

Light diffuser in white crystal glass, mouth blown and handmade. Unleaded glass of average thickness 4mm. Color obtained in the mixture and not painted.